



Screw Base Type Fuse Links



► Applications

Protection against overload and short-circuit in electric lines (type gG), also available for protection of semiconductor parts and equipments against short-circuit (type aR) and protection of motors (type aM).

Rated voltage up to 1140V; Rated current up to 630A; Working frequency 50Hz AC; Rated breaking capacity up to 50KA. Compliant with GB13539 and IEC269.

► Design Features

Variable cross-section fuse element made from pure metal sealed in cartridge made from high-duty ceramic. Fuse tube filled with chemically treated high-purity quartz sand as arc-extinguishing medium. Indicator springs out when fuse cuts to give caution.

► Basic Data

The models, dimensions, ratings are shown in Figures 3.1~3.7 and Tables 3 .

Table 3

Cat. No.	Models		Cross-reference		Sizes	Rated voltage (V)	Rated current (A)	Dimensions/size (mm)					Weight (g)
	MIRO		gG(Normal)	aR(Fast)				Fig.	ϕA	ϕC	ϕD	L	
0301	RO21	RS21	5SB E27	5SD	DII	500	2~6	3.1	6	22	13	50	24.8
							8~10	3.1	8	22	13	50	
							13	3.1	8	22	15	50	
							16	3.1	10	22	15	50	
							20	3.1	12	22	15	50	
							25	3.1	14	22	15	50	
0302	RO22	RS22	5SB E33	5SD	DIII	500	30~40	3.1	16	27	20	50	48.1
							50	3.1	18	27	20	50	
							63	3.1	20	27	20	50	
0303	RO23	RS23	-	-	DIII	500	2~6	3.1	6	27	20	70	64
							8~10	3.1	8	27	20	70	
							16	3.1	10	27	20	70	
							20	3.1	12	27	20	70	
							25	3.1	14	27	20	70	
							35	3.1	16	27	20	70	
							50	3.1	18	27	20	70	
							63	3.1	20	27	20	70	
0304	RO24	RS24	E16	-	-	500	2~6	3.1	6	12.5	11.3	50	11.7
							10	3.1	8	12.5	11.3	50	
							16	3.1	10	12.5	11.3	50	
							20~25	3.1	12	12.5	11.3	50	
0305	RO27	RS27	BLA	BLC	-	600	3~10	3.1	8	12.5	11.5	50	13.1
0306	RO28	RS28	BLA	BLC	-	600	15~20	3.1	10	12.5	11.5	50	14.5
0307	RO29	RS29	BLA	BLC	-	600	25~40	3.1	14	12.5	11.5	50	16.4

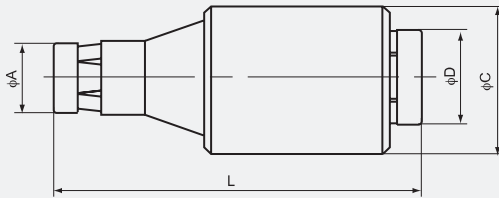

Figure 3.1

Table 3 (cont.)

Cat. No.	Models		Cross-reference		Sizes	Rated voltage (V)	Rated current (A)	Dimensions/size (mm)					Weight (g)		
	MIRO		gG(Normal)	aR(Fast)				Fig.	ϕA	ϕB	ϕC	ϕD		L	
0308	RO26	RS26	E14	-	D01	380	2~6	3.2	5	7.3	10.6	10	36	12.7	
							10	3.2	5	8.5	10.6	10	36		
							16	3.2	5	9.7	10.6	10	36		
					D02		20	3.2	8.5	11	15	14	36		13.8
							25	3.2	8.5	12	15	14	36		
							35	3.2	8.5	13.3	15	14	36		
							50	3.2	8.5	14.5	15	14	36		
					D03		63	3.2	8.5	16	15	14	36		15.6
							80	3.2	17	22	21	43	43		
							100	3.2	17	25	22	21	43		

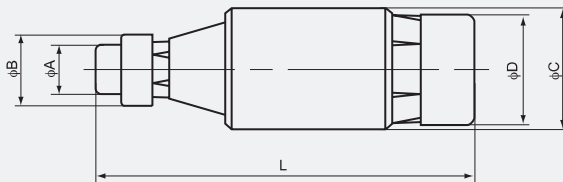

Figure 3.2



Table 3 (cont.)

Cat. No.	Models		Cross-reference	Sizes	Rated voltage (V)	Rated current (A)	Dimensions/size (mm)				Weight (g)	
	MIRO gG(Normal)	aR(Fast)					Fig.	ϕA	ϕB	ϕC		L
0309	RL1-15	RLS1-15	-	-	380	2~15	3.3	13	16.5	13	32	13
0310	RL1-60	RLS1-60	-	-	380	20~60	3.3	19	26.5	19	49	50.7

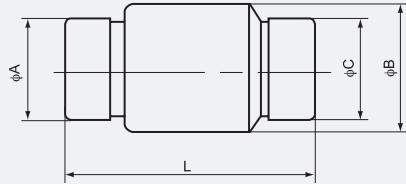

Figure 3.3



Low-Voltage Fuses
 Fuse links



Table 3 (cont.)

Cat. No.	Models		Cross-reference	Sizes	Rated voltage (V)	Rated current (A)	Dimensions/size (mm)					Weight (g)	
	MIRO gG(Normal)	aR(Fast)					gG(Normal)	aR(Fast)	Fig.	ϕA	ϕB		ϕC
0311	RL1-100	RLS1-100	-	-	380	50~100	3.4	6.5	27.5	32.5	27.5	60	92.8
0312	RO201	RS201	5SB BLA	DIV	600	80	3.4	5	-	33.5	28.5	63	112.2
			RL6-100				3.4	7	-	33.5	28.5	63	115
0313	RO202	RS202	5SB BLA	DV	600	150~350	3.4	8	-	45	38	63	200.5
0314	RO203	RS203	5SB BLA	-	600	400~630	3.4	10	-	60	50	63	320

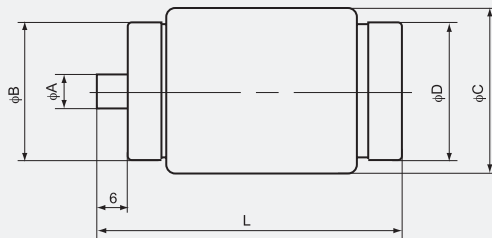

Figure 3.4



Table 3 (cont.)

Cat. No.	Models		Cross-reference	Sizes	Rated voltage (V)	Rated current (A)	Dimensions/size (mm) Fig.	Weight (g)
	MIRO gG(Normal)	aR(Fast)						
0315	RL1-200	RLS1-200	-	-	380	160~200	See figure 3.5	204

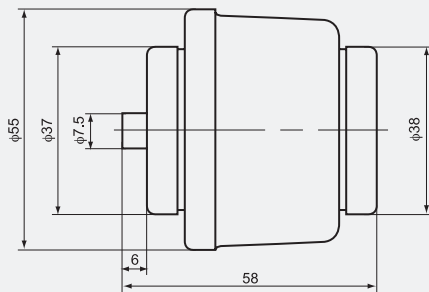

Figure 3.5



Table 3 (cont.)

Cat. No.	Models		Cross-reference	Sizes	Rated voltage (V)	Rated current (A)	Dimensions/size (mm) Fig.	Weight (g)
	MIRO							
0316	RO25	RS25	-	-	500	2~25	See figure 3.6	31.2

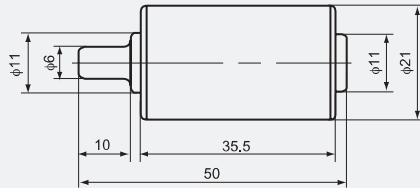

Figure 3.6

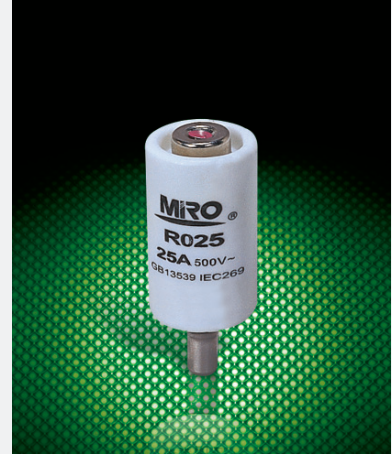

Table 3 (cont.)

Cat. No.	Models		Cross-reference	Sizes	Rated voltage (V)	Rated current (A)	Dimensions/size (mm) Fig.	Weight (g)
	MIRO							
0317	RL5-40	-	-	-	1140	2~40	See figure 3.7	22

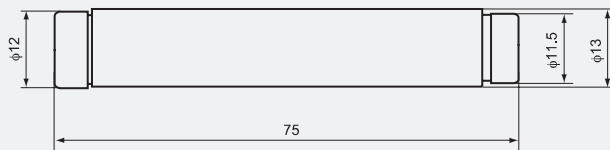
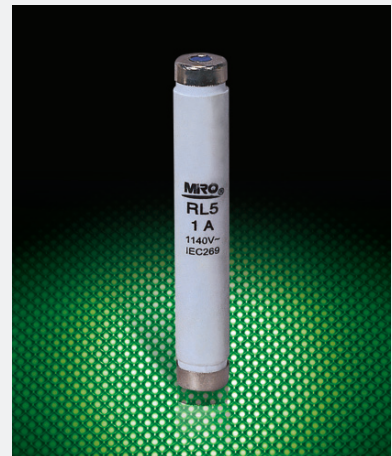
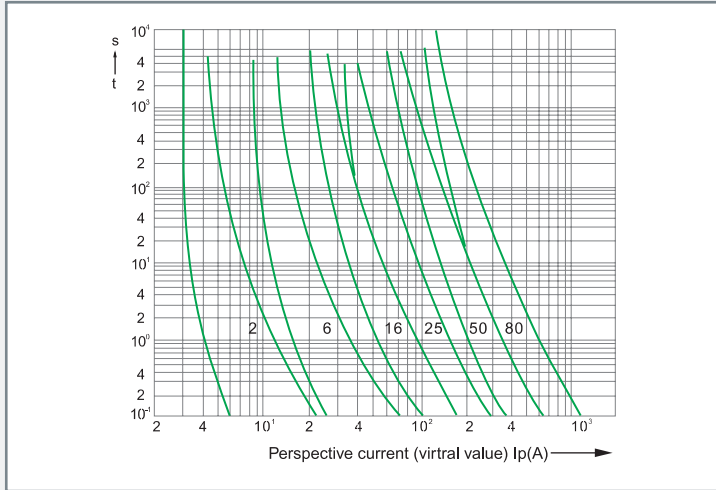

Figure 3.7



► **Characteristics Curve**



Time-current rang of "gG" fuse links

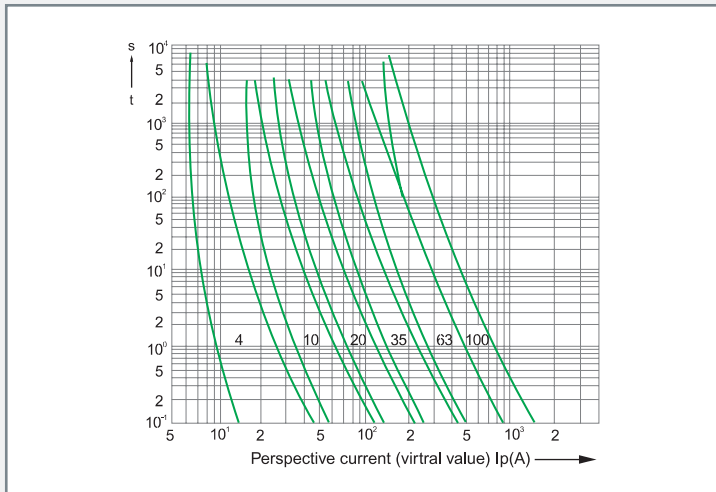

Time-current rang of "gG" fuse links

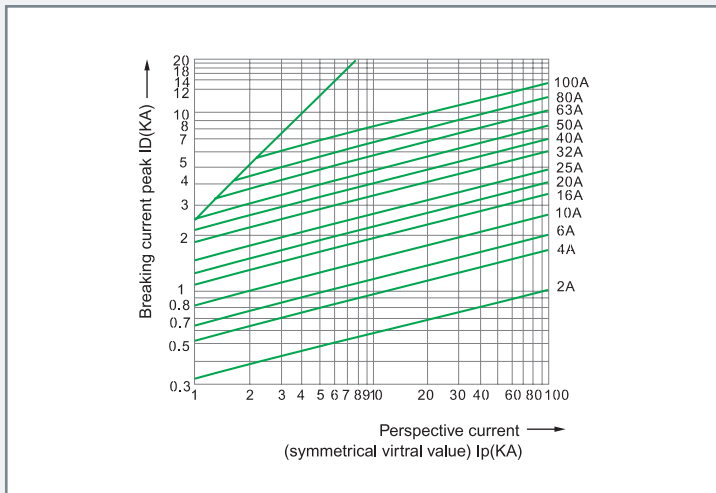

Breaking current characteristics curve of "gG" fuse links



▶ **Characteristics Curve**

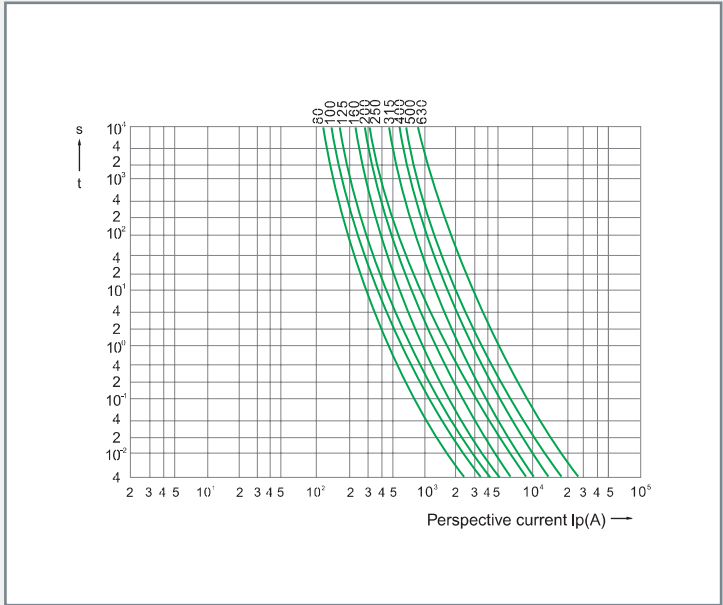
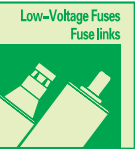

Time-current rang of "gG" fuse links RO201~203

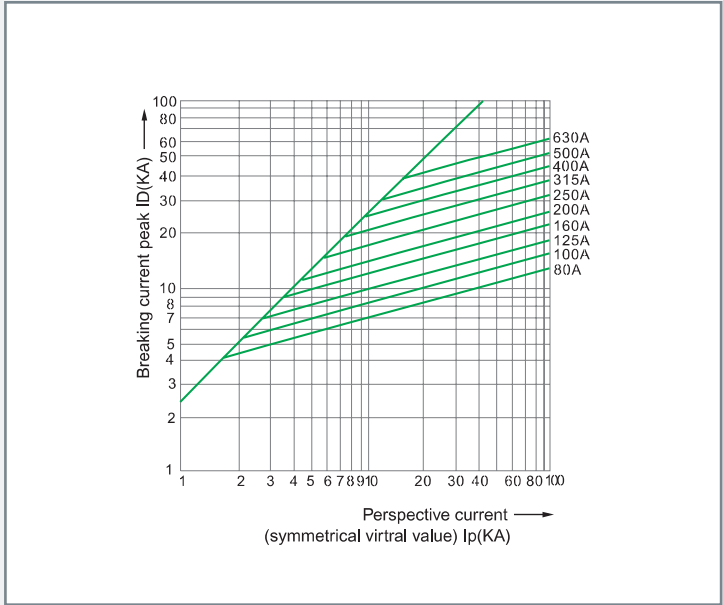

Breaking current characteristics curve of "gG" fuse links RO201~203